

## External insulation system

### PRODUCT

**webertherm MW** is a high performance ETICS/EIFS based on stonewool insulation (also known as rockwool) glued and mechanically fixed, reinforced with an imbedded mesh cloth, base coat, and finished with a textured colored render.

### SYSTEM COMPOSITION

<b>Insulation board</b>	Stone wool
<b>Fixing</b>	Adhesive <b>webertherm glue</b> and mechanical <b>webertherm anc</b>
<b>Reinforcement</b>	Fiber glass mesh <b>webertherm mesh</b>
<b>1st base coat</b>	<b>webertherm base</b> 2-3 mm
<b>2nd base coat</b>	<b>webertherm base</b> 2-3 mm
<b>Finish</b>	Primer and thin coat Acrylic or Silicate finish <b>weberpas PR 300</b> , <b>weberpas deco 350</b> or <b>weberpas PR SIL</b> , <b>weberpas deco SIL</b>
<b>Accessories</b>	<b>webertherm alu base</b> , <b>webertherm edge</b>

Refer to TDS of each product

### TECHNICAL APPROVAL

European Technical Approval ETA-04/0077 acc. ETAG 004:2011

### SUITABLE SUBSTRATE

New sound brick / block or existing rendered / unrendered sound masonry / AAC blocks / plaster

### SURFACE PREPARATION

The substrate should be well plane. If rendered, hammer test and remove all existing debonding or defect in render. For existing substrates, or where required on new substrates, clean and wash with clean water and leave for 48 hours. Brush down to remove all moss / growth. Make good boss areas by using appropriate concrete repair mortars or Premixed mortars and plasters Sodamco Weber range (refer to current product data sheets for further information). Fit full system base and stop beads, where required, with fixings as approved and supplied by Sodamco Weber.

### PRODUCT APPLICATION

Draw a horizontal line to at 15 cm from the highest point of the ground. For balconies, terraces, stairs, the starting level is set 1 to 2 cm above ground level.

Position the profiles (rails having convenient space depending on the thickness of the boards), and fix them well by drilling to allow the passage of the dowels. The space

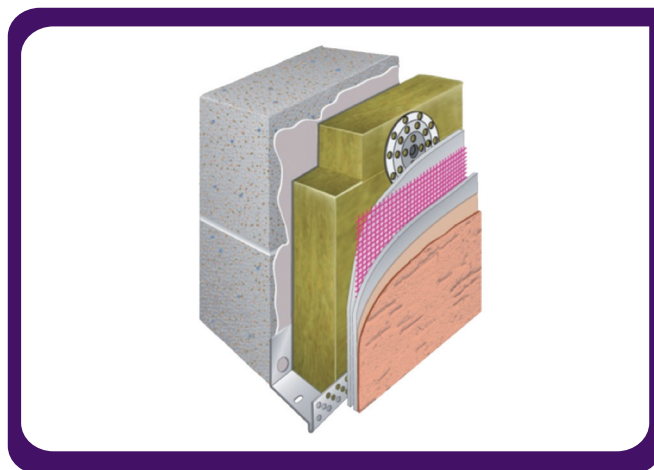

between each dowels must be around 30 cm. Fix the reinforcement Mesh on the rail. The mesh will be then glued by the webertherm base on the board.

The panels are laid from board to board in successive rows of stone, starting from the low level established by the profile, in a way to have equal long and short faces. the panel joints must not coincide with the profile junctions.

A part on the edge of the insulating board has been cut out so it can be inserted in the window-sill according to its size and type. A thinner board can then be positioned so as to insulate the wall below window-sill.

After cutting the boards, mark them to recognize the place of each.

At the windows and door corner, cut L-shaped panels to reduce the risk of cracks. After fixing the board, reinforce the wedging by fixing diagonally a mesh of around 30x40 cm.

Mix 25 kg of **webertherm glue** with 5.5 to 6 liters potable water and apply to back of the insulant board as specified (approx 6 kg/m<sup>2</sup>). Apply **webertherm glue** in peripheral and transverse strips 15 to 20 mm thick. Mortar must not flow back and forth between panel joints. Position board on wall, tap lightly into position to reconcile edges. Always check alignment and level with a plastic trowel and Aluminum bar. Next day, after setting, mechanically fix to the masonry substrate using specified **webertherm anc** at the rate of 5 psc per board. The anchor should enter around 5 cm in the masonry substrate. the entire anchor must not in any case protrude from the surface of the insulation. For mechanical protection and straightness at the edges, an angel profile is

used with reinforced glass cloth. Cut it into suitable length, and fix it with webertherm glue.

In the case of open joints, fill with polyurethane foam or a thin layer of insulation board, never with mortar. Mix 25 kg of **webertherm base** with 5.5 to 6 liters portable water and apply around 3 mm thick incorporating **webertherm mesh** 4x4 standard glass fiber. Smooth it and leave it to set. After setting (preferably next day), apply further 3 mm to form a nominal 6 mm thick monolithic coat. Depending on the successive finishing, rule off with a straight edge to achieve satisfactory inplane surface. Remove all trowel marks and dress off surface smooth with a sponge. Allow to dry.

Apply **weberpas prime** (acrylic or silicate) tinted primer by roller, spray or brush. Apply and work **weberpas deco** (acrylic or silicate) to an acceptable texture using a stainless steel / plastic trowel, all in accordance with manufacturer's printed instructions.

## PRECAUTIONS

Immediately place the insulation board on the substrate, ensuring that no **webertherm glue** mixture gets boards joints. Do not allow the **webertherm glue** mixture to form a skin before positioning the board on the substrate as it will affect the bond strength.

Joints between adjacent insulation boards should be reduced to the minimum.

In hot weather, it is preferable to apply the product early morning or late afternoon.

Avoid work under heavy windy condition in which case the product may dry fast and cracks might appear.

For additional information, please contact one of our Sales Engineers.

## CLEAN UP

Clean the tools with water after use. Cured materials can only be removed mechanically.

## SAFETY PRECAUTIONS

The product contains cement powders which, when mixed with water, release alkalis that could be harmful to the skin. It is preferable that the application be done in a ventilated area, and to wear protective gear for hands, eyes and respiratory system and to avoid breathing of the dust. Splashes on the skin should be washed away by cleaning with soap and water. In case of contact with eyes, wash thoroughly with clean water. If swallowed, do not induce vomiting; in both cases seek medical attention. The product is non-flammable.

## DISCLAIMER

While the company guarantees its products against defective materials, the use and application of these products are made without guarantee since the conditions of their application are beyond its control. It is recommended to verify with the company that the product is suitable for the intended use, and that this Data Sheet version is the latest one. The company may modify it without prior notice. Technical characteristics are listed for guidance only. For more information, please contact the company's office in your location.

## NOTE

The information included on this Technical Data Sheet is the sole property of Saint-Gobain Middle East Holding (previously SODAMCO Holding). The unauthorized disclosure, use, dissemination or copying (either whole or partial) of this data sheet or any information it contains, is prohibited and subject to legal pursuit.

PG:08